

SAMPLING VALVE

V101 SERIES

The V101 Series Sampling Valve is used to bleed excessive air pressure out of system or to sample liquid in system to view condition and clarity. A locknut prevents the screw from backing out of base in high vibration situations.

Standard Materials:

- Brass construction
- Stainless Steel ball seated in brass

Operating Conditions:

- For pressures up to 6000 PSI (41370 kPa)

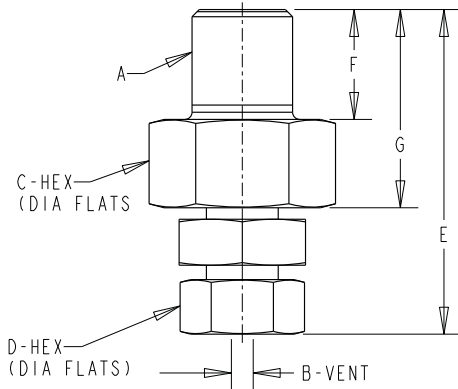

V101 Series								
Part No.	A NPTF	B inches (mm)	C inches (mm)	D inches (mm)	E inches (mm)	F inches (mm)	G inches (mm)	Features
V101	1/8	.076 (1.93)	.56 (14.22)	.38 (9.65)	1.19 (30.23)	.38 (9.65)	.69 (17.53)	With Locknut

Dimensions and specifications are subject to change without notice. Not all items are Made-To-Stock, contact us for availability.

02/14

Ph : 920-682-6877
Fx : 920-684-7210

LDI Industries

sales@ldi-industries.com
www.ldi-industries.com